



KEELSON ROW TOWNHOMES
HARBOUR VILLAGE ON BALD HEAD ISLAND



Few places evoke the lure of the sea quite like Bald Head Island. Positioned two nautical miles off North Carolina's southern coast, the island's serpentine creeks, maritime forest and quiet beaches culminate dramatically at the point of Cape Fear. Because the island is reachable only by passenger ferry or private boat, its 10-acre marina serves as both a gateway to the community and the center of activity. Known as Harbour Village, the quaint neighborhood surrounding the marina is reminiscent of a 19th century whaling port, with its cedar-clad homes, bed and breakfast inns, small boutiques and dockside restaurants. Nearby, boat slips ranging up to 100 feet are available via membership in the Bald Head Island Yacht Club.



Into this idyllic setting, we're proud to introduce four new homes, each built to a grand scale. Positioned along Keelson Row in Harbour Village, these exquisite townhomes overlook the marina,



One Keelson Row

Three Keelson Row

river and ocean to the west and Bald Head Creek to the east, providing remarkable light and vistas from sunup to sunset.





The designers of the Keelson Row Townhomes found inspiration in American coastal architecture as well as European housing styles. From their corner brackets, working shutters, and deep porches, to their heart pine flooring, cherry interior doors and handcrafted tiles, each detail in these homes was carefully considered by a team of award-winning architects.

One Keelson Row



The Keelson Row Townhome designers used traditional building materials in novel ways to create homes that are rooted in history, but also of their time. The result: classic architectural elements pair with contemporary interior finishes for a combination that is elegant, unexpected and fresh.

FIRST FLOOR
ENTRY & SLEEPING AREA



The first floorplans for Keelson Row 1A and 1B offer two spacious bedrooms on the first level, each with a private bath. A welcoming front porch runs the length of the first floor, while the back door of each townhome opens onto its own landscaped courtyard, ideal for entertaining friends and family or enjoying al fresco dining. Across the courtyard, both townhomes include their own cart garage and crofter cottage with a bedroom and full bath.

In Keelson Row 1A and 1B, the open living, kitchen and dining areas are on the second floor to take full advantage of sweeping views of the harbour, river and Atlantic Ocean beyond. Wide second story porches provide a lofty vantage point for relaxing in a rocker and watching the boats come and go. In the kitchen, quartz countertops, sleek faucets and stainless steel appliances create a streamlined, sophisticated atmosphere, while Caribbean heart pine floors, Indian raw silk pendant light shades, and handcrafted tiles lend warmth and character.

SECOND FLOOR
MAIN LIVING AREA



On the top floor, both townhomes offer two additional bedrooms, each with its own spa-inspired bathroom. A family room at the top of the stairs includes a bar, making a late evening cocktail or early morning cup of coffee convenient for upstairs guests.



THIRD FLOOR
MASTER & SLEEPING AREA



Three Keelson Row



Like their sister townhomes, Keelson Row 3A and 3B convey a commanding presence along the harbourfront with their distinctive rooflines. Wide porches span the front facade, providing gallery seating for viewing the marina, river and ocean. These homes also enjoy magnificent panoramas of Bald Head Creek and Old Baldy Lighthouse from their east and south-facing elevations.

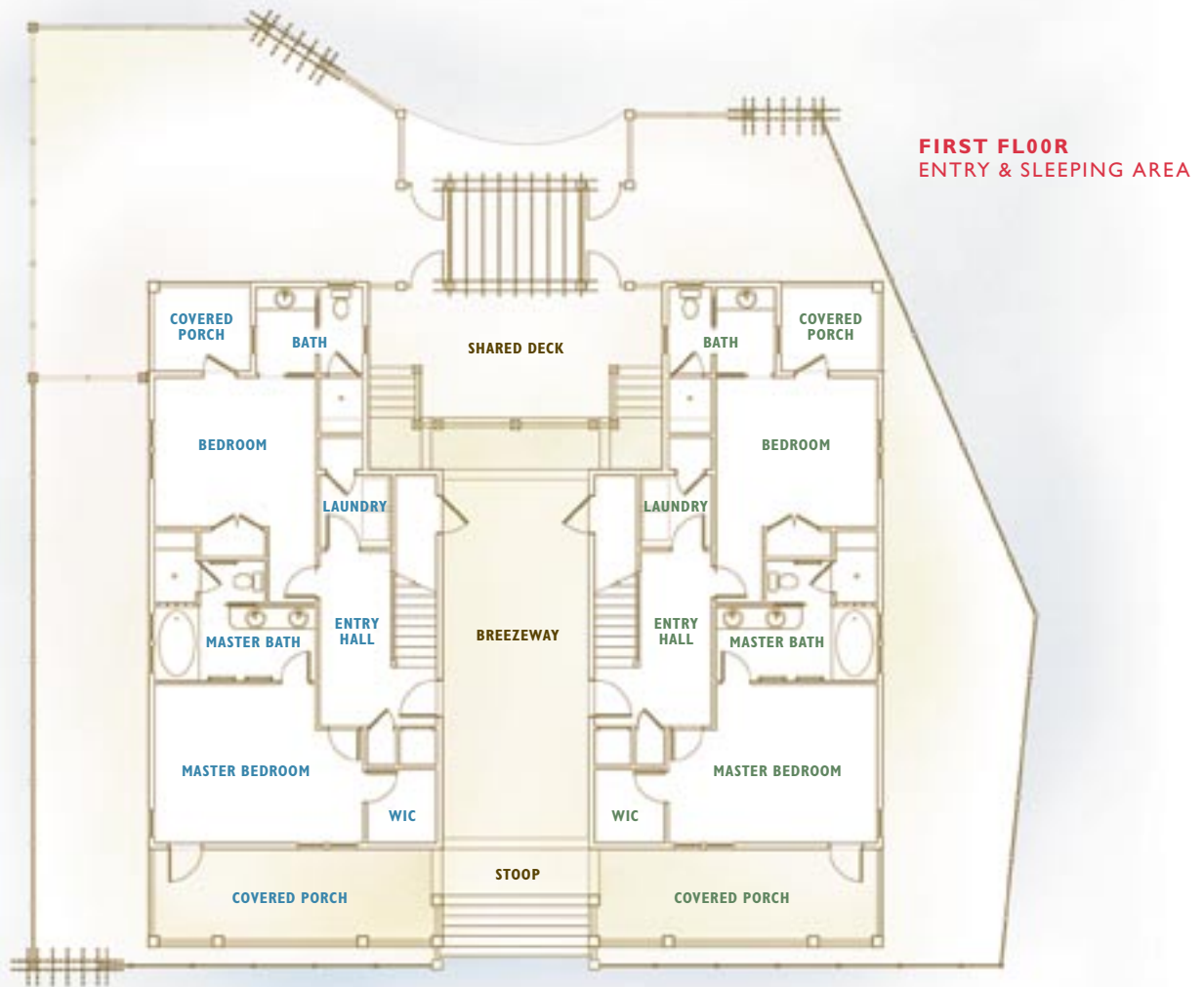

Two spacious bedrooms and baths are on the first floor of Keelson Row 3A and 3B, while a charming paved courtyard leads to a cart garage and crofter cottage with a bedroom and full bath. In the main house, the master bedroom has direct access to the front porch, while the back bedroom opens onto a private deck for experiencing scenes of the nearby marsh. Tumbled natural stone tiles in the entry hall and lush, durable carpet in the bedrooms exude a sense of quality and timelessness.



The second floor in Keelson Row 3A and 3B features open kitchen, dining and living areas where families and friends can congregate. Ten-foot ceilings add to the feeling of spaciousness, while a private study and sitting alcove provide cozy corners for reading a book or enjoying a quiet conversation. Like its neighboring Keelson Row Townhomes 1A and 1B, the kitchens have solid maple cabinets, lovely glass tiles, and dramatic light fixtures.

SECOND FLOOR MAIN LIVING AREA

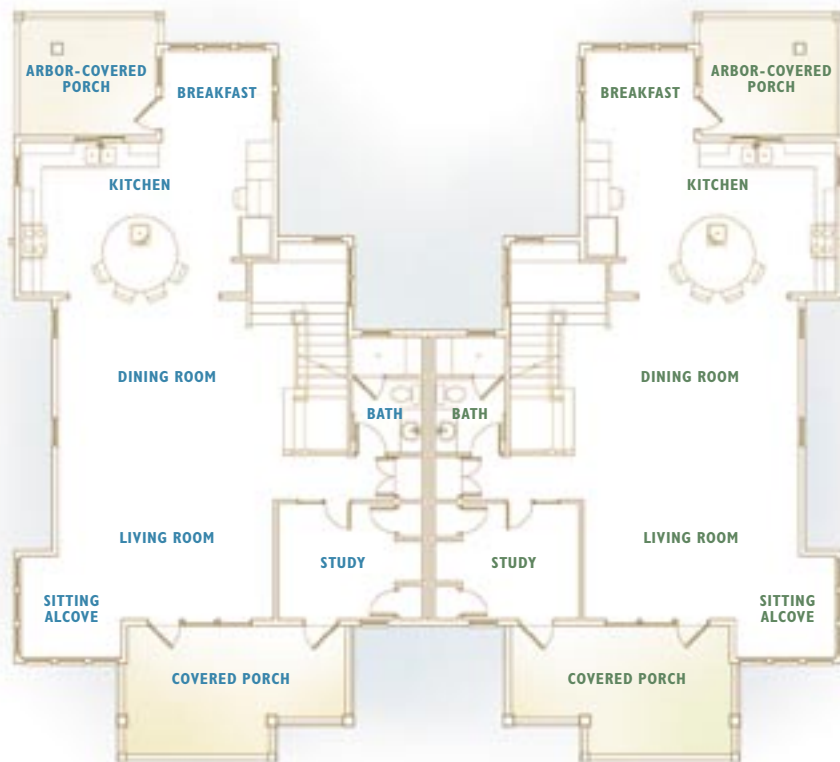

Upstairs, two roomy bedrooms and baths provide additional space for guests. In both townhomes the back bedroom offers a sitting area designed to be a reading nook or nursery, while the front bedroom adjoins a covered balcony overlooking the harbour. In keeping with the townhomes' harmonious balance of private and communal space, both bedrooms open to a shared family room and bar, perfect for enjoying a movie or ball game.



THIRD FLOOR MASTER & SLEEPING AREA

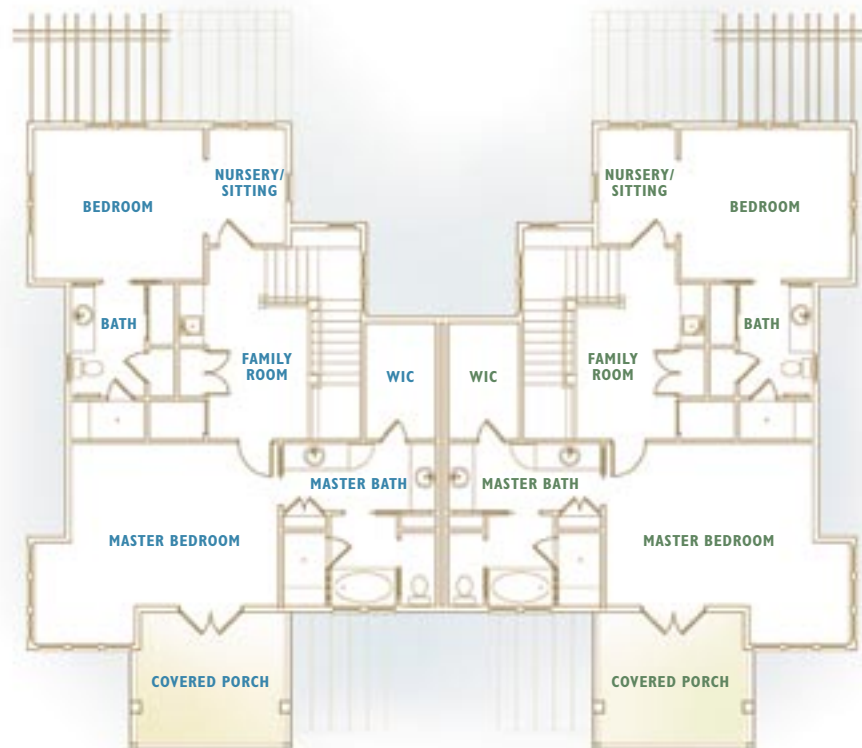



Specifications

GENERAL FEATURES

Four bedrooms, four-and-a-half baths in main house, additional bedroom and bath in crofter cottage

High-efficiency electric split-system heat pump, monitor-ready fire alarm system, fire sprinklers, sound-proofed common wall, covered porches, paved courtyard, separate cart garage and crofter cottage, marl driveway with concrete apron at street, exterior shower, exterior trash enclosure, landscaping and irrigation system

EXTERIOR

White cedar siding with bleaching oil, standing seam metal roof, Andersen vinyl-covered wood windows

ENTRY/FOYER

Tumbled natural stone, beadboard wainscot

KITCHEN

Caribbean heart pine floors, pendant lighting, maple cabinets with craftsman-style doors, solid surface countertops with under-mount sink, tile backsplash, stainless steel appliances including refrigerator, dishwasher, range, microwave

BREAKFAST ROOM

Caribbean heart pine floors, wall sconces, ceiling fan

LAUNDRY

Front-loading washer and dryer, solid surface countertops

LIVING ROOM

Caribbean heart pine floors, beadboard wainscot, ceiling fan

SITTING ALCOVE

Caribbean heart pine floors, beadboard wainscot, built-in bench seating

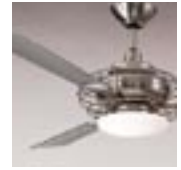
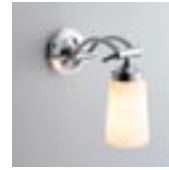

DINING ROOM

Caribbean heart pine floors,
beadboard wainscot

STUDY

Caribbean heart pine floors,
ceiling fan

SECOND FLOOR LANDING & UPPER FOYER

Caribbean heart pine floors,
wall sconces

THIRD FLOOR FAMILY ROOM

Carpet floors, built-in bar with
solid surface countertops, sink,
maple cabinets with craftsman-
style doors

BEDROOMS

Carpet floors, ceiling fan

MASTER BATH 1

Ceramic tile floors, solid surface
countertop vanity with under-
mounted sink, maple cabinets
with craftsman-style doors,
ceramic tile shower, soaking tub
with tile surround

MASTER BATH 2

Ceramic tile floors, solid surface
countertop vanity with under-
mounted sink, maple cabinets
with craftsman-style doors,
ceramic tile shower, soaking tub

BATH 3

Ceramic tile floors, solid surface
countertop vanity with under-
mounted sink, maple cabinets
with craftsman-style doors,
ceramic tile tub/shower

BATH 4

Ceramic tile floors, solid surface
countertop vanity with under-
mounted sink, maple cabinets
with craftsman-style doors,
ceramic tile tub/shower

POWDER ROOM

Ceramic tile floors, vanity with
solid surface countertops, maple
cabinets with craftsman-style
doors



The Keelson Row Townhomes are built by BHI Construction Company, the building company affiliated with Bald Head Island Limited and recognized by the building industry as a leader in quality design and construction. To learn more please contact Bald Head Island Limited Real Estate Sales at 1-800-579-9030 or email salesinternet@bhisland.com.



Site plans, elevations, renderings and floorplans shown are not to scale and are intended for illustrative purposes only. All descriptions and specifications are approximate and are subject to change without notice at the discretion of the developer.

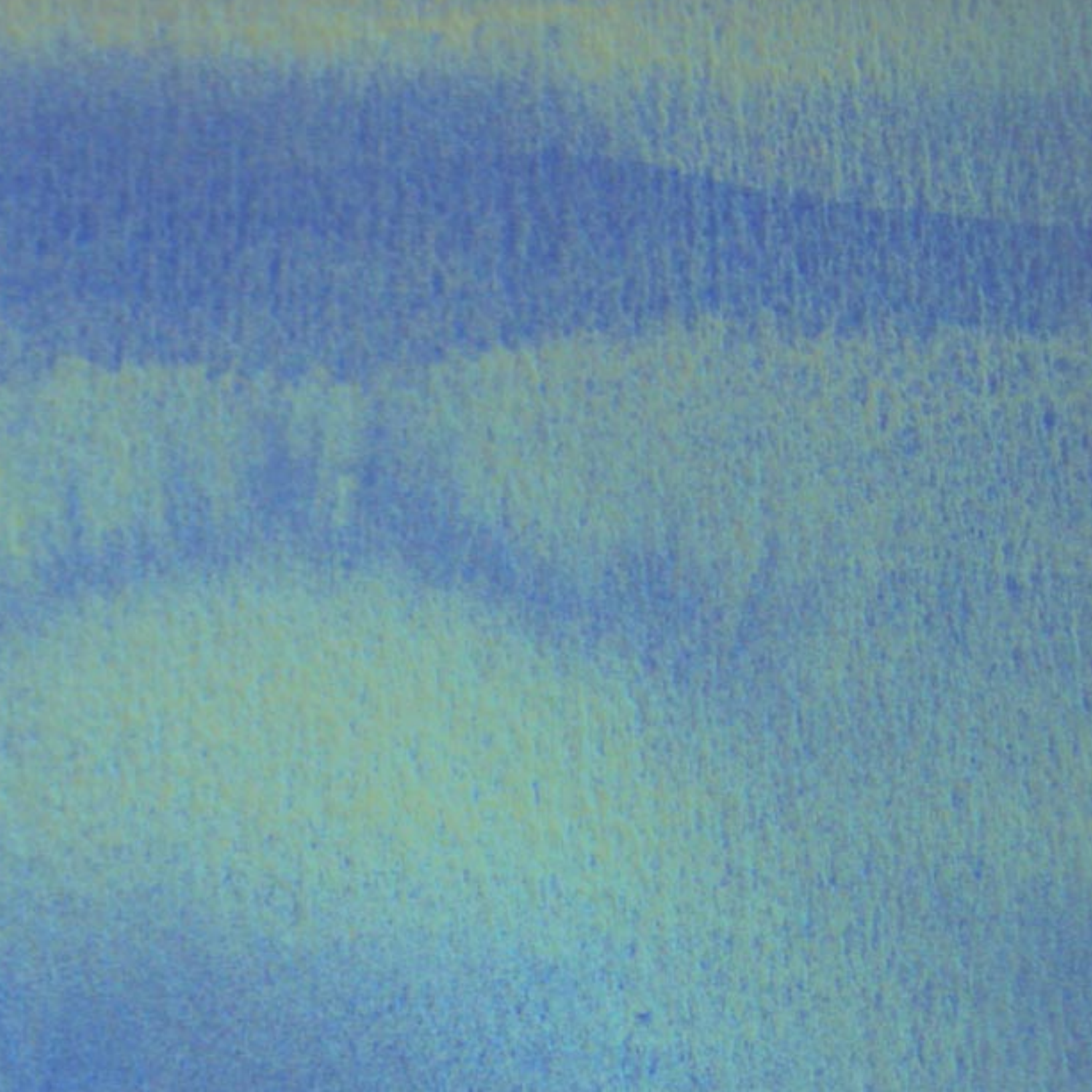



Bald Head Island Limited Real Estate Sales
4 Marina Wynd or 4 Maritime Way · Bald Head Island, NC 28461
1-800-579-9030 · www.baldheadisland.com